

# Somfy: Programming Guide

## 3 Options Available

### 5 or 1 Channel Remote



Channel 5 preprogrammed to operate all shades

### 5 or 1 Channel Wall Switch

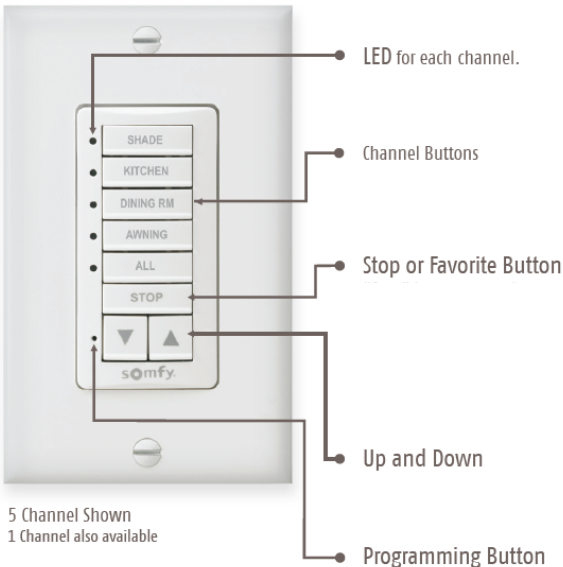

Channel 5 preprogrammed to operate all shades

### 16 Channel Remote

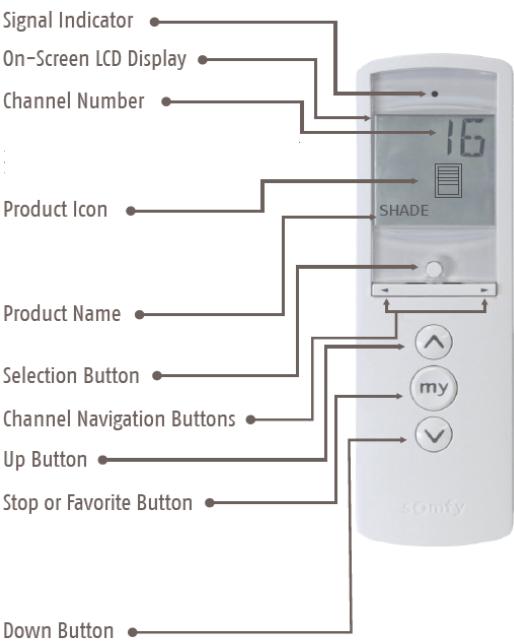

Channel 1 preprogrammed to operate all shades

## INSTALL WALL MOUNT HOLDER

**1**

Attach threaded anchor to wall using supplied screw and plastic anchor as needed.

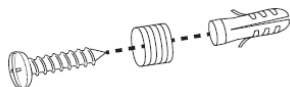

**2**

Screw post to threaded anchor.

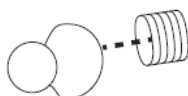

**3**

Place Remote Control on post.



## INSTALL AND/OR REPLACE REMOTE BATTERY

**1**

With a small screwdriver remove the screw to release the back cover from the remote.

**2**

Remove existing battery (if replacing battery) and install new battery with positive (+) side facing up.

**3**

Replace cover

BACK OF REMOTE

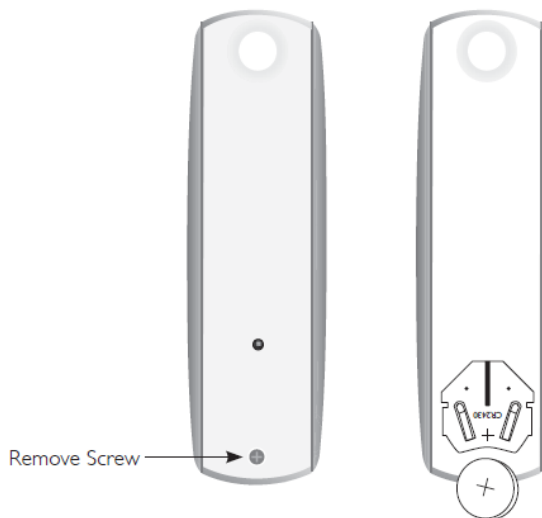

**\* Required:** CR2430 3V Lithium Coin Cell Battery

# Initial Setup Programming – Plug-In

This set of *Initial Setup Programming* instructions is to be used to set the limits on a motor that has been reset to factory settings with the remote control paired to the motor on the desired channel.

## Factory Reset Steps (If Required) - \*This will erase all saved limits\*

1. Perform a “Dual Power Cut”  
(Sequence Outlined Below)
  - Unplug shade for **6** seconds
  - Plug-in shade for **10** seconds
  - Unplug shade for **6** seconds
  - Plug-in shade. Shade will move
2. Select the remote channel to be paired with the motor.
3. Press and hold the **PROGRAMMING BUTTON** on the remote. Continue to hold the programming button until the motor jogs **2 times** and has finished jogging.  
(1 Jog = 1 Up + 1 Down Movement)

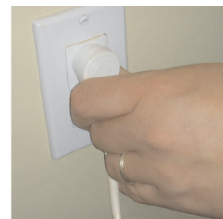

The PROGRAMMING BUTTON for all handheld remotes is located on the back of the remote.



## Initial Setup - Programming Steps

1. Connect power to the motor you wish to program, remove power from any other motors on the same channel as to avoid modifying the limits of other shades on the channel (120V, 24V DC Transformer, or 12V Battery Wand)
2. Place the motor into “Programming Mode”  
On the remote channel to be paired to the motor  
Press and hold **UP AND DOWN** on the remote.  
Motor jogs once to confirm
3. Check Motor Direction  
Press **UP OR DOWN**  
If the motor travels opposite the remote buttons  
Press and hold **MY(STOP)**  
Motor jogs once to confirm direction reversed
4. Setting Limits  
Travel to the desired UPPER limit by pressing the **UP** button on the remote  
Once at the desired UPPER position, press and hold **MY(STOP) AND DOWN**  
The motor will travel downward  
Stop motor at the desired LOWER limit by pressing the **MY(STOP)** button  
Make fine adjustments up or down by pressing **UP OR DOWN**  
Press and hold **MY(STOP) AND UP**. The motor will travel to the upper limit
5. Confirm Limit Settings  
Press and hold **MY(STOP)**. Motor jogs once to confirm
6. Exit Programming Mode  
Press and hold the Programming button on the back of the remote. Motor jogs once to confirm

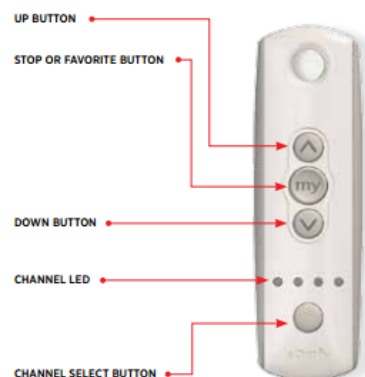

# Initial Setup Programming – Battery & LV

This set of *Initial Setup Programming* instructions is to be used to set the limits on a motor that has been reset to factory settings with the remote control paired to the motor on the desired channel.

## **Factory Reset Steps (If Required) - \*This will erase all saved limits\***

Hold the **PROGRAMMING BUTTON** on the motor head until the motor jogs 3 times  
(1 Jog = 1 Up + 1 Down Movement)

(The programming button is recessed on the motor head)

All motor limits will be erased and need to be reestablished



## **Initial Setup - Programming Steps**

1. Connect power to the motor you wish to program, remove power from any other motors on the same channel as to avoid modifying the limits of other shades on the channel (120V, 24V DC Transformer, or 12V Battery Wand)
2. Place the motor into "Programming Mode"  
On the remote channel to be paired to the motor  
Press and hold **UP AND DOWN** on the remote.  
Motor jogs once to confirm
3. Check Motor Direction  
Press **UP OR DOWN**  
If the motor travels opposite the remote buttons  
Press and hold **MY(STOP)**  
Motor jogs once to confirm direction reversed
4. Setting Limits  
Travel to the desired UPPER limit by pressing the **UP** button on the remote  
Once at the desired UPPER position, press and hold **MY(STOP) AND DOWN**  
The motor will travel downward  
Stop motor at the desired LOWER limit by pressing the **MY(STOP)** button  
Make fine adjustments up or down by pressing **UP OR DOWN**  
Press and hold **MY(STOP) AND UP**. The motor will travel to the upper limit
5. Confirm Limit Settings  
Press and hold **MY(STOP)**. Motor jogs once to confirm
6. Exit Programming Mode  
Press and hold the Programming button on the back of the remote. Motor jogs once to confirm

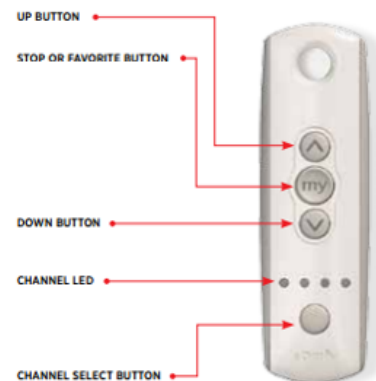

# Remote & Motor Pairing – Plug-In

When no remotes are paired to a motor it is ALWAYS necessary to perform a factory reset of the motor to pair with a remote. This will require following the steps for initial setup programming.

## Factory Reset Steps (If Required) - \*This will erase all saved limits\*

1. Perform a “Dual Power Cut”  
(Sequence Outlined Below)
  - Unplug shade for **6** seconds
  - Plug-in shade for **10** seconds
  - Unplug shade for **6** seconds
  - Plug-in shade. Shade will move
2. Select the remote channel to be paired with the motor.
3. Press and hold the **PROGRAMMING BUTTON** on the remote. Continue to hold the programming button until the motor jogs **2 times** and has finished jogging.  
(1 Jog = 1 Up + 1 Down Movement)



The PROGRAMMING BUTTON for all handheld remotes is located on the back of the remote.



## Initial Setup - Programming Steps

1. Connect power to the motor you wish to program, remove power from any other motors on the same channel as to avoid modifying the limits of other shades on the channel (120V, 24V DC Transformer, or 12V Battery Wand)
2. Place the motor into “Programming Mode”  
On the remote channel to be paired to the motor  
Press and hold **UP AND DOWN** on the remote.  
Motor jogs once to confirm
3. Check Motor Direction  
Press **UP OR DOWN**  
If the motor travels opposite the remote buttons  
Press and hold **MY(STOP)**  
Motor jogs once to confirm direction reversed
4. Setting Limits  
Travel to the desired UPPER limit by pressing the **UP** button on the remote  
Once at the desired UPPER position, press and hold **MY(STOP) AND DOWN**  
The motor will travel downward  
Stop motor at the desired LOWER limit by pressing the **MY(STOP)** button  
Make fine adjustments up or down by pressing **UP OR DOWN**  
Press and hold **MY(STOP) AND UP**. The motor will travel to the upper limit
5. Confirm Limit Settings  
Press and hold **MY(STOP)**. Motor jogs once to confirm
6. Exit Programming Mode  
Press and hold the Programming button on the back of the remote. Motor jogs once to confirm

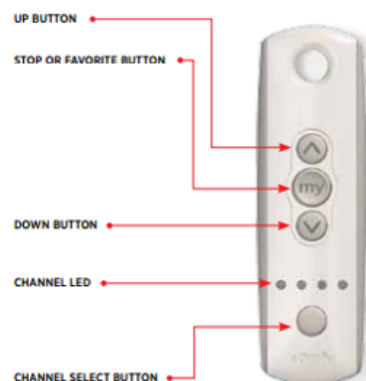

# Remote & Motor Pairing – Battery & LV

When no remotes are paired to a motor it is ALWAYS necessary to perform a factory reset of the motor to pair with a remote. This will require following the steps for initial setup programming.

## Factory Reset Steps (If Required) - \*This will erase all saved limits\*

Hold the **PROGRAMMING BUTTON** on the motor head until the motor jogs 3 times  
(1 Jog = 1 Up + 1 Down Movement)

(The programming button is recessed on the motor head)

All motor limits will be erased and need to be reestablished



## Initial Setup - Programming Steps

1. Connect power to the motor you wish to program, remove power from any other motors on the same channel as to avoid modifying the limits of other shades on the channel (120V, 24V DC Transformer, or 12V Battery Wand)
2. Place the motor into "Programming Mode"  
On the remote channel to be paired to the motor  
Press and hold **UP AND DOWN** on the remote.  
Motor jogs once to confirm
3. Check Motor Direction  
Press **UP OR DOWN**  
If the motor travels opposite the remote buttons  
Press and hold **MY(STOP)**  
Motor jogs once to confirm direction reversed
4. Setting Limits  
Travel to the desired UPPER limit by pressing the **UP** button on the remote  
Once at the desired UPPER position, press and hold **MY(STOP) AND DOWN**  
The motor will travel downward  
Stop motor at the desired LOWER limit by pressing the **MY(STOP)** button  
Make fine adjustments up or down by pressing **UP OR DOWN**  
Press and hold **MY(STOP) AND UP**. The motor will travel to the upper limit
5. Confirm Limit Settings  
Press and hold **MY(STOP)**. Motor jogs once to confirm
6. Exit Programming Mode  
Press and hold the Programming button on the back of the remote. Motor jogs once to confirm

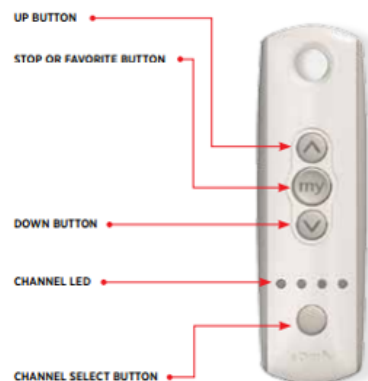

# Reverse Motor Direction – Plug-In

To reverse the motor a factory reset **MUST** be performed and the motor must be reprogrammed from factory settings. See below to execute a factory reset and go through initial setup.

## **Factory Reset Steps (If Required) - \*This will erase all saved limits\***

1. Perform a “Dual Power Cut”  
(Sequence Outlined Below)
  - Unplug shade for **6** seconds
  - Plug-in shade for **10** seconds
  - Unplug shade for **6** seconds
  - Plug-in shade. Shade will move
2. Select the remote channel to be paired with the motor.
3. Press and hold the **PROGRAMMING BUTTON** on the remote. Continue to hold the programming button until the motor jogs **2 times** and has finished jogging.  
(1 Jog = 1 Up + 1 Down Movement)



The PROGRAMMING BUTTON for all handheld remotes is located on the back of the remote.



## **Initial Setup - Programming Steps**

1. Connect power to the motor you wish to program, remove power from any other motors on the same channel as to avoid modifying the limits of other shades on the channel  
(120V, 24V DC Transformer, or 12V Battery Wand)
2. Place the motor into “Programming Mode”  
On the remote channel to be paired to the motor, press and hold **UP AND DOWN** on the remote. Motor jogs once to confirm
3. Check Motor Direction  
Press **UP OR DOWN**  
**If when pressing UP OR DOWN the motor travels in the wrong direction, press and hold MY(STOP). Motor jogs once to confirm**
4. Setting Limits  
Travel to the desired UPPER limit by pressing the **UP** button on the remote  
Once at the desired UPPER position, press and hold **MY(STOP) AND DOWN**  
The motor will travel downward  
Stop motor at the desired LOWER limit by pressing the **MY(STOP)** button  
Make fine adjustments up or down by pressing **UP OR DOWN**  
Press and hold **MY(STOP) AND UP**. The motor will travel to the upper limit
5. Confirm Limit Settings  
Press and hold **MY(STOP)**. Motor jogs once to confirm
6. Exit Programming Mode  
Press and hold the Programming button on the back of the remote. Motor jogs once to confirm

# Reverse Motor Direction – Battery & LV

To reverse the motor a factory reset **MUST** be performed and the motor must be reprogrammed from factory settings. See below to execute a factory reset and go through initial setup.

## Factory Reset Steps (If Required) - \*This will erase all saved limits\*

Hold the **PROGRAMMING BUTTON** on the motor head until the motor jogs 3 times  
(1 Jog = 1 Up + 1 Down Movement)

(The programming button is recessed on the motor head)

All motor limits will be erased and need to be reestablished



## Initial Setup - Programming Steps

1. Connect power to the motor you wish to program, remove power from any other motors on the same channel as to avoid modifying the limits of other shades on the channel (120V, 24V DC Transformer, or 12V Battery Wand)
2. Place the motor into "Programming Mode"  
On the remote channel to be paired to the motor, press and hold **UP AND DOWN** on the remote. Motor jogs once to confirm
3. Check Motor Direction  
Press **UP OR DOWN**  
If when pressing **UP OR DOWN** the motor travels in the wrong direction, press and hold **MY(STOP)**. Motor jogs once to confirm
4. Setting Limits  
Travel to the desired UPPER limit by pressing the **UP** button on the remote  
Once at the desired UPPER position, press and hold **MY(STOP) AND DOWN**  
The motor will travel downward  
Stop motor at the desired LOWER limit by pressing the **MY(STOP)** button  
Make fine adjustments up or down by pressing **UP OR DOWN**  
Press and hold **MY(STOP) AND UP**. The motor will travel to the upper limit
5. Confirm Limit Settings  
Press and hold **MY(STOP)**. Motor jogs once to confirm
6. Exit Programming Mode  
Press and hold the Programming button on the back of the remote. Motor jogs once to confirm



# Adding/Deleting Remotes & Channels

To mirror a channel you must have the currently programmed remote available as well as a free channel on either the current remote or the new remote to available to accept the copied settings

**!! IMPORTANT !!** – Before adding or deleting a remote control from a motor, you must remove the power supply from any shades paired on the same channel prior to performing any programming. To complete this you must unplug the battery wand from battery motors or unplug the cord from any AC motors that you will not be setting.\* If your shades are hardwired you must consult an electrician for help with this procedure.

\*If you do not complete this step you could cause damage to your shades and/or modify the limits on another shade inadvertently.

## Mirroring Remote Settings – To copy channel settings to a different channel or remote

1. Select the channel on the original remote you wish to copy the settings from
2. Press and hold the **PROGRAMMING BUTTON** on the original remote until the motor associated to the channel jogs once (Jog = 1 UP and 1 Down movement)
3. Select the new channel on the current remote, or the channel on the new remote where you wish to copy the original motor pairing settings
4. Press and hold the **PROGRAMMING BUTTON** on the new remote tuned to the desired channel, or the current remote tuned to the new channel until the motor you are copying jogs once (Jog = 1 UP and 1 Down movement)  
The jog confirms the mirror of current settings



Programming Button

## Deleting Remote Settings – To delete channel settings from a mirrored channel/remote

1. Select the channel on the remote you wish to keep the motor paired with
2. Press and hold the **PROGRAMMING BUTTON** on the remote to remain until the motor associated to the channel jogs once (Jog = 1 UP and 1 Down movement)
3. Select the channel on the remote you wish to remove if applicable
4. Press and hold the **PROGRAMMING BUTTON** on the second remote until the motor jogs once (Jog = 1 UP and 1 Down movement)  
The jog confirms the deletion of the remote



Programming Button

\*If you disconnected the power to any shades be sure to restore the power to the motors to regain remote control of the shade operation.

# Adjusting Limits

This set of *Adjusting Limits* instructions is to be used to make changes to the defined limits on a shade without performing a factory reset. Follow the below instructions to modify the UPPER and LOWER limits

**!! IMPORTANT !!** – Before adjusting the limits on any shade, you must remove the power supply from any shades paired on the same channel prior to performing any programming. To complete this you must unplug the battery wand from battery motors or unplug the cord from any AC motors that you will not be adjusting.\* If your shades are hardwired you must consult an electrician for help with this procedure.

\*If you do not complete this step you could cause damage to your shades and/or modify the limits on another shade inadvertently

## Adjusting Limits - Modify The LOWER Limit

1. Press **DOWN** on the remote to send the motor to its current lower limit  
Do not stop the motor manually
2. Press and hold **UP AND DOWN** simultaneously until the motor jogs  
(Jog = 1 UP and 1 Down movement)
3. Adjust the motor to the newly desired lower limit  
Press the **UP OR DOWN** buttons to move the motor
4. Press and hold **MY(STOP)** on the remote until the motor jogs.  
This confirms the new lower limit

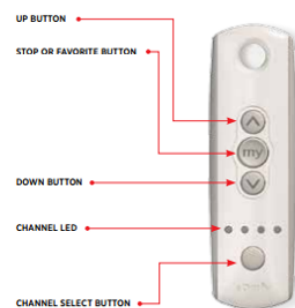

## Adjusting Limits - Modify The UPPER Limit

1. Press **UP** on the remote to send the motor to its current UPPER limit  
Do not stop the motor manually
2. Press and hold **UP AND DOWN** simultaneously until the motor jogs  
(Jog = 1 UP and 1 Down movement)
3. Adjust the motor to the newly desired upper limit  
Press the **UP OR DOWN** buttons to move the motor
4. Press and hold **MY(STOP)** on the remote until the motor jogs.  
This confirms the new upper limit

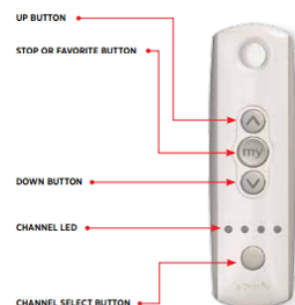

\*If you disconnected the power to any shades to adjust the limits on one motor be sure to restore the power to the motors to regain remote control of the shade operation.

# Favorite Position

This set of *Favorite Position* instructions is to be used to make set or delete the MY position for a shade or group of shades paired to a specific remote channel. The MY position can be set to anywhere between the upper and lower limit on a motor. Only one MY position can be saved per motor.

**!! IMPORTANT !!** – Before adding or deleting the MY position on any shade, you must remove the power supply from any shades paired on the same channel prior to performing any programming. To complete this you must unplug the battery wand from battery motors or unplug the cord from any AC motors that you will not be setting.\* If your shades are hardwired you must consult an electrician for help with this procedure.

\*If you do not complete this step you could cause damage to your shades and/or modify the limits on another shade inadvertently

## Favorite Position - Set the “MY” Position

1. Press **UP OR DOWN** on the remote to operate the motor  
At the desired position press the **MY(STOP)** button to stop the motor
2. Press and hold **MY(STOP)** until the motor jogs  
(Jog = 1 UP and 1 Down movement)  
The MY position is now saved to the motor

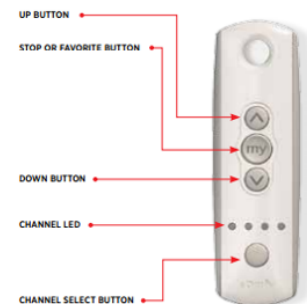

## Favorite Position - Activate the “MY” Position

Press **MY(STOP)** on the remote from any motor position to send the motor to the stored MY position location

The motor should be completely stationary before activating

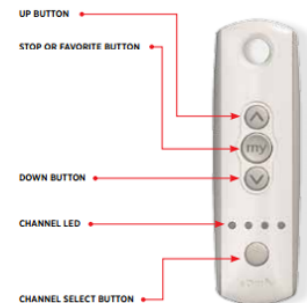

## Favorite Position - Delete the “MY” Position

1. Press **MY(STOP)** on the remote from any motor position to send the motor to the stored MY position location
2. Press and hold **MY(STOP)** for 5 seconds  
The motor will jog once to confirm MY position deletion  
(Jog = 1 UP and 1 Down movement)

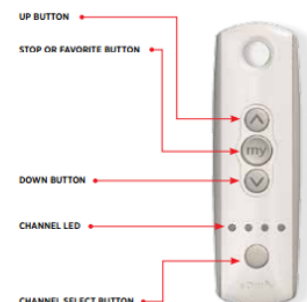

# Drapery Track Programming

---

Each Somfy battery & plug-in motor will come preprogrammed from The Shade Store.  
Use the following instructions to execute the options available for a motorized drapery track.

---

**!! IMPORTANT !!** – Before executing any of the below options you must have your remote paired to the drapery motor. This process is the same as for any other Somfy motor. Please see *remote & motor pairing*. As with all other programming steps, adding or deleting a remote control from a motor requires you to remove the power supply from any shades paired on the same channel prior to performing any programming. To complete this you must unplug the battery wand from battery motors or unplug the cord from any AC motors that you will not be setting.\* If your shades are hardwired you must consult an electrician for help with this procedure.

\*If you do not complete this step you could cause damage to your shades and/or modify the limits on another shade inadvertently.

## **Programming the Control Points**

1. Press and hold the OPEN/UP and CLOSE/DOWN buttons simultaneously on the remote until the drapery jogs.
2. Briefly press and hold the OPEN/UP or CLOSE/DOWN button, the drapery automatically traverses to record both the open and closed hard stop positions.
3. Checking the Direction of Operation:
  - a) Press the OPEN/UP button
    - If the drapery opens, the direction of rotation is correct
    - If the drapery closes, the direction of rotation is incorrect: move to the next step.
  - b) Press the (STOP) button until the drapery jogs, the direction of rotation has been modified.
  - c) Press the OPEN/UP button to confirm that the drapery opens.
4. Press the PROGRAMMING button on the back of the remote until the motor jogs to confirm the setting.

## **Programming MY Position**

1. Recording MY Position: To set the MY position, move the drapery to the desired position with the OPEN/UP or CLOSE/DOWN buttons. Press the (STOP) button until the drapery jogs.
2. Delete the MY Position: To delete the MY position, move to the current MY position, then press the (STOP) button until the drapery jogs.

## **Modifying the Motor Rotation Direction**

1. Press the OPEN/UP or CLOSE/DOWN buttons to move the drapery away from the limit.
2. Press and hold the OPEN/UP and CLOSE/DOWN buttons simultaneously until the drapery jogs once.
3. Press the (STOP) button until the drapery jogs to confirm the direction change.

# Drapery Track Programming

---

Each Somfy battery & plug-in motor will come preprogrammed from The Shade Store.  
Use the following instructions to execute the options available for a motorized drapery track.

---

**!! IMPORTANT !!** – Before executing any of the below options you must have your remote paired to the drapery motor. This process is the same as for any other Somfy motor. Please see *remote & motor pairing*. As with all other programming steps, adding or deleting a remote control from a motor requires you to remove the power supply from any shades paired on the same channel prior to performing any programming. To complete this you must unplug the battery wand from battery motors or unplug the cord from any AC motors that you will not be setting.\* If your shades are hardwired you must consult an electrician for help with this procedure.

\*If you do not complete this step you could cause damage to your shades and/or modify the limits on another shade inadvertently.

## **Adjusting the Limits on a Programmed Motor**

- OPEN Limits Adjustment:
  1. Press the OPEN/UP button to move the drapery to the limits to be re-adjusted.
  2. Press and hold the OPEN/UP and CLOSE/DOWN buttons simultaneously until the drapery jogs.
  3. Press and hold the OPEN/UP or CLOSE/DOWN buttons to move the drapery to the new desired position.
  4. To confirm the new limit, press and hold the (STOP) button until the drapery jogs.
- CLOSE Limit Adjustment:
  1. Press the CLOSE/DOWN button to move the drapery to the limit to be re-adjusted.
  2. Press and hold the OPEN/UP and CLOSE/DOWN buttons simultaneously until the drapery jogs.
  3. Press and hold the OPEN/UP or CLOSE/DOWN buttons to move the drapery to the new desired position.
  4. To confirm the new limit, press and hold the (STOP) button until the drapery jogs.

## **Activating the Touch Motion Feature (By default feature is turned off)**

1. Press the OPEN/UP or CLOSE/DOWN buttons to move the drapery away from the limits.
2. Press and hold the OPEN/UP and CLOSE/DOWN button simultaneously until the drapery jogs.
3. To activate the Standard Sensitivity setting:
  - Press the OPEN/UP and CLOSE/DOWN buttons simultaneously until the drapery jogs twice.
  - Press the (STOP) button until the drapery jogs to confirm the setting.
4. To activate the Low Sensitivity setting:
  - Press the OPEN/UP and CLOSE/DOWN buttons simultaneously until the drapery jogs once. Then press the OPEN/UP and CLOSE/DOWN buttons simultaneously until the drapery jogs 3 more times.
  - Press the (STOP) button until the drapery jogs to confirm the setting.

## **Adjustment of Speed Setting:**

1. Press and hold both the (STOP) and OPEN/UP buttons simultaneously until the drapery starts to open and close automatically without stopping.
2. Press OPEN/UP to increase speed, CLOSE/DOWN to decrease speed.
3. Press (STOP) button until the drapery jogs to confirm the setting.

# Drapery Track Programming

---

Each Somfy battery & plug-in motor will come preprogrammed from The Shade Store.  
Use the following instructions to execute the options available for a motorized drapery track.

---

**!! IMPORTANT !!** – Before executing any of the below options you must have your remote paired to the drapery motor. This process is the same as for any other Somfy motor. Please see *remote & motor pairing*. As with all other programming steps, adding or deleting a remote control from a motor requires you to remove the power supply from any shades paired on the same channel prior to performing any programming. To complete this you must unplug the battery wand from battery motors or unplug the cord from any AC motors that you will not be setting.\* If your shades are hardwired you must consult an electrician for help with this procedure.

\*If you do not complete this step you could cause damage to your shades and/or modify the limits on another shade inadvertently.

## **Adding/Deleting a Remote**

1. Press and hold the PROGRAMMING BUTTON of either the motors receiver or a remote already in memory until the drapery jogs. The motor is now in PROGRAMMING MODE.
2. Briefly press the PROGRAMMING BUTTON on the remote to add or delete the remote until the drapery jogs once.

## **Return to Factory Settings: (Delete all remotes and erase all setting changes)**

1. Press and hold the receiver PROGRAMMING BUTTON on the motor head until the drapery jogs 3 times. All settings will be erased.

# Drapery Track Programming

---

Each Somfy battery & plug-in motor will come preprogrammed from The Shade Store.  
Use the following instructions to execute the options available for a motorized drapery track.

---

**!! IMPORTANT !!** – Before executing any of the below options you must have your remote paired to the drapery motor. This process is the same as for any other Somfy motor. Please see *remote & motor pairing*. As with all other programming steps, adding or deleting a remote control from a motor requires you to remove the power supply from any shades paired on the same channel prior to performing any programming. To complete this you must unplug the battery wand from battery motors or unplug the cord from any AC motors that you will not be setting.\* If your shades are hardwired you must consult an electrician for help with this procedure.

\*If you do not complete this step you could cause damage to your shades and/or modify the limits on another shade inadvertently.

## **Programming the Control Points**

1. Press and hold the OPEN/UP and CLOSE/DOWN buttons simultaneously on the remote until the drapery jogs.
2. Briefly press and hold the OPEN/UP or CLOSE/DOWN button, the drapery automatically traverses to record both the open and closed hard stop positions.
3. Checking the Direction of Operation:
  - a) Press the OPEN/UP button
    - If the drapery opens, the direction of rotation is correct
    - If the drapery closes, the direction of rotation is incorrect: move to the next step.
  - b) Press the (STOP) button until the drapery jogs, the direction of rotation has been modified.
  - c) Press the OPEN/UP button to confirm that the drapery opens.
4. Press the PROGRAMMING button on the back of the remote until the motor jogs to confirm the setting.

## **Programming MY Position**

1. Recording MY Position: To set the MY position, move the drapery to the desired position with the OPEN/UP or CLOSE/DOWN buttons. Press the (STOP) button until the drapery jogs.
2. Delete the MY Position: To delete the MY position, move to the current MY position, then press the (STOP) button until the drapery jogs.

## **Modifying the Motor Rotation Direction**

1. Press the OPEN/UP or CLOSE/DOWN buttons to move the drapery away from the limit.
2. Press and hold the OPEN/UP and CLOSE/DOWN buttons simultaneously until the drapery jogs once.
3. Press the (STOP) button until the drapery jogs to confirm the direction change.

# Drapery Track Programming

Each Somfy battery & plug-in motor will come preprogrammed from The Shade Store.  
Use the following instructions to execute the options available for a motorized drapery track.

**!! IMPORTANT !!** – Before executing any of the below options you must have your remote paired to the drapery motor. This process is the same as for any other Somfy motor. Please see *remote & motor pairing*. As with all other programming steps, adding or deleting a remote control from a motor requires you to remove the power supply from any shades paired on the same channel prior to performing any programming. To complete this you must unplug the battery wand from battery motors or unplug the cord from any AC motors that you will not be setting.\* If your shades are hardwired you must consult an electrician for help with this procedure.

\*If you do not complete this step you could cause damage to your shades and/or modify the limits on another shade inadvertently.

## **Adjusting the Limits on a Programmed Motor**

- OPEN Limits Adjustment:
  1. Press the OPEN/UP button to move the drapery to the limits to be re-adjusted.
  2. Press and hold the OPEN/UP and CLOSE/DOWN buttons simultaneously until the drapery jogs.
  3. Press and hold the OPEN/UP or CLOSE/DOWN buttons to move the drapery to the new desired position.
  4. To confirm the new limit, press and hold the (STOP) button until the drapery jogs.
- CLOSE Limit Adjustment:
  1. Press the CLOSE/DOWN button to move the drapery to the limit to be re-adjusted.
  2. Press and hold the OPEN/UP and CLOSE/DOWN buttons simultaneously until the drapery jogs.
  3. Press and hold the OPEN/UP or CLOSE/DOWN buttons to move the drapery to the new desired position.
  4. To confirm the new limit, press and hold the (STOP) button until the drapery jogs.

## **Activating the Touch Motion Feature (By default feature is turned off)**

1. Press the OPEN/UP or CLOSE/DOWN buttons to move the drapery away from the limits.
2. Press and hold the OPEN/UP and CLOSE/DOWN button simultaneously until the drapery jogs.
3. To activate the Standard Sensitivity setting:
  - Press the OPEN/UP and CLOSE/DOWN buttons simultaneously until the drapery jogs twice.
  - Press the (STOP) button until the drapery jogs to confirm the setting.
4. To activate the Low Sensitivity setting:
  - Press the OPEN/UP and CLOSE/DOWN buttons simultaneously until the drapery jogs once. Then press the OPEN/UP and CLOSE/DOWN buttons simultaneously until the drapery jogs 3 more times.
  - Press the (STOP) button until the drapery jogs to confirm the setting.

## **Adjustment of Speed Setting:**

1. Press and hold both the (STOP) and OPEN/UP buttons simultaneously until the drapery starts to open and close automatically without stopping.
2. Press OPEN/UP to increase speed, CLOSE/DOWN to decrease speed.
3. Press (STOP) button until the drapery jogs to confirm the setting.



# Drapery Track Programming

---

Each Somfy battery & plug-in motor will come preprogrammed from The Shade Store.  
Use the following instructions to execute the options available for a motorized drapery track.

---

**!! IMPORTANT !!** – Before executing any of the below options you must have your remote paired to the drapery motor. This process is the same as for any other Somfy motor. Please see *remote & motor pairing*. As with all other programming steps, adding or deleting a remote control from a motor requires you to remove the power supply from any shades paired on the same channel prior to performing any programming. To complete this you must unplug the battery wand from battery motors or unplug the cord from any AC motors that you will not be setting.\* If your shades are hardwired you must consult an electrician for help with this procedure.

\*If you do not complete this step you could cause damage to your shades and/or modify the limits on another shade inadvertently.

## **Adding/Deleting a Remote**

1. Press and hold the PROGRAMMING BUTTON of either the motors receiver or a remote already in memory until the drapery jogs. The motor is now in PROGRAMMING MODE.
2. Briefly press the PROGRAMMING BUTTON on the remote to add or delete the remote until the drapery jogs once.

## **Return to Factory Settings: (Delete all remotes and erase all setting changes)**

1. Press and hold the receiver PROGRAMMING BUTTON on the motor head until the drapery jogs 3 times. All settings will be erased.