



AMX INTEGRATION OVERVIEW:

Take your motorized window treatment experience to the next level by integrating them into your AMX smart home control system. The integration supports isolated shade control and features a two-way communication system offering real time shade position.

The Wi-Fi Bridge is available for purchase through The Shade Store. It can integrate up to 30 shades and supports plug 'n play RS485 Serial integration through a RJ9 port conveniently located on the back of the Bridge.

GETTING STARTED:

In order to integrate your motorized window treatments with AMX, you will need to have:

- Downloaded the free app via the Apple App Store (available under iPhone apps) or the Google Play Store.
- Purchased one or more Wi-Fi Bridges depending on size of the space.
- Integrated your motorized window treatments onto The Shade Store app.

INSTRUCTIONS INCLUDED:

- Set up instructions for both The Shade Store app & Wi-Fi Bridge
- AMX Driver Installation Instructions
- AMX Driver Guide
- Integration Diagram
- Integration FAQ's
- Support Resources

ABOUT THE APP:

The Shade Store app allows for control of your motorized window treatments through your smartphone/tablet.

The app allows for:

- Individual and group control
- Scene control
- Timer functionality

GETTING STARTED:

In order to control your motorized window treatments through The Shade Store app, you will need to have:

- Downloaded the free app via the Apple App Store (available under iPhone apps) or the Google Play Store.
- Purchased one or more Wi-Fi Bridges depending on size of the space.



WI-FI BRIDGE TECHNICAL SPECIFICATIONS:

- Radio Frequency range: -60 feet (no obstructions)
- Radio Frequency: 433 MHz
- Wi-Fi: 2.4 GHz
- Power: 120V AC
- For Indoor Use Only

SETUP BEST PRACTICES:

- Bridge must be within signal range of both the motorized window treatments and the Wi-Fi router.
- Wi-Fi network must be visible.
- Environments with multiple WAPs (wireless access points) may need to temporarily disable all but one.
- Security settings may need to be temporarily disabled.

CAPABILITIES:

- Motors per Bridge: 30
- Locations per account: 5
- Wi-Fi Bridges per location: 5
- Rooms per Location: 20
- Scenes per Location: 20
- Timers per Location: 20

WHAT'S IN THE BOX:

- 1x Shade Store Wi-Fi Bridge (a)
- 1x 6" Short Power Cord (b)
- 1x 12" Long Power Cord (c)
- 1x Outlet Power Plug (d)
- 2x Antiskid Pads (e)

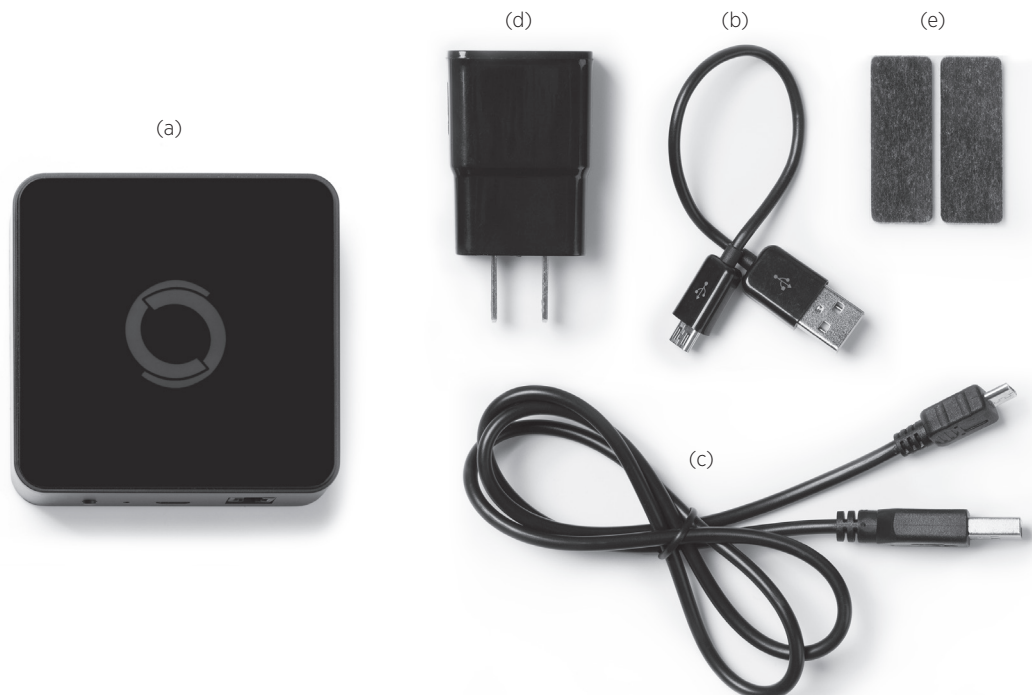

UNPACKING THE WI-FI BRIDGE:



1. Unpack the Wi-Fi Bridge.



2. Insert USB end of the power cord (long or short) into the outlet power plug.



3. Insert the micro USB end of the power cord (long or short) into the Wi-Fi Bridge.



4. Place the bridge in a centrally located position in your home and plug in to outlet. (You may need to experiment with different locations to be able to reach the desired shades).

SETTING UP THE APP:



1. Open TheShadeStore mobile application.



2. If required, create a new account. Select Sign Up on the bottom left corner of the screen.



3. Creating an account will require an email address and a password.



4. SIGN IN with your account information.

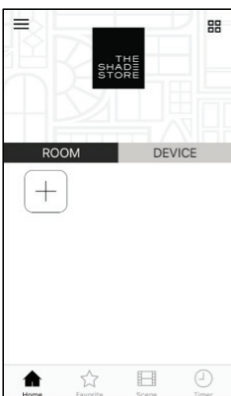

5. Link the application to the new Wi-Fi Bridge. Select the menu button in the upper left corner of the home screen (3 lines).

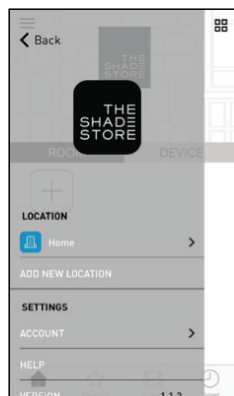

6. Select the default "Home" option under LOCATION to open Location Settings.

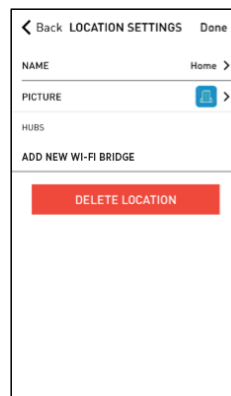

7. Select "ADD NEW WI-FI BRIDGE" to enter the pairing process.

PAIRING THE APP & WI-FI BRIDGE:



8. Follow on screen instructions to pair the new Wi-Fi Bridge to the application Ensure Wi-Fi Bridge is plugged in. Select "Next".

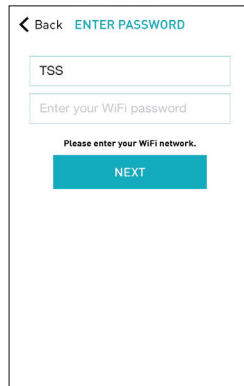

9. SSID will populate based on the current network your device is connected to. Enter your Wi-Fi password. Select "Next".

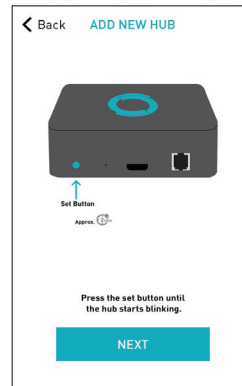

10. Hold the Wi-Fi Bridge set button for 2 seconds. The bridge will start blinking blue to signify it is ready to pair to the network. Select "Matching".

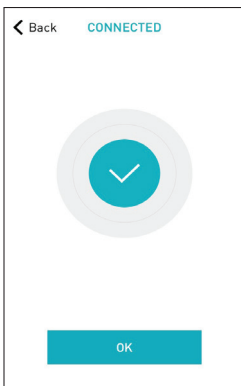

11. The Wi-Fi Bridge will attempt to pair to your Wi-Fi network for 60 seconds. Select "Set Hub" after success.

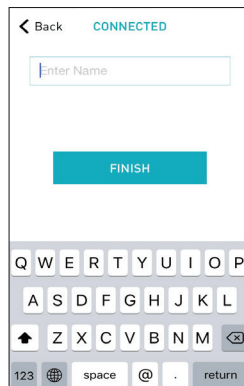

12. Name your Wi-Fi Bridge to complete the Wi-Fi connection process.

PAIRING TROUBLESHOOTING:

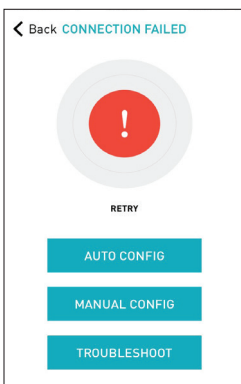

13. There are a number of factors that will influence the network pairing process. Some networks require more time to make the initial communication links with the application servers.

In the event you receive the "Connection Failed" screen, we suggest you reattempt the pairing sequence by selecting "Auto Configuration". This will redirect you to complete the above process again. If then unsuccessful again you may choose the second connection path by selecting "Manual Configuration". See Manual Configuration steps below.

MANUAL CONFIGURATION

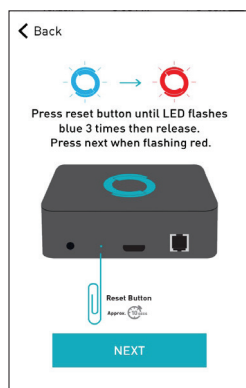

14. Using a paper clip, press and hold the recessed button on the Wi-Fi Bridge until the Bridge blinks blue 3 times. Press next when the Bridge begins blinking red.

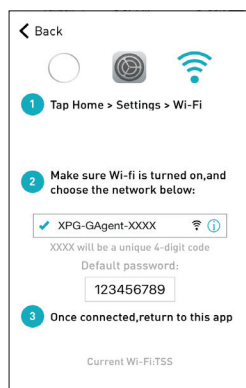

15. Using your home button exit TheShadeStore app and enter your Wi-Fi settings. Select the XPG-GAgent-XXXX network and enter the default password 123456789. Return to TheShadeStore app.

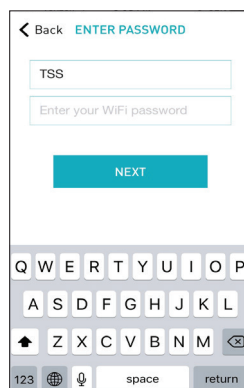

16. You will be prompted to enter the password for your Wi-Fi network. Enter your Wi-Fi password. Click next.

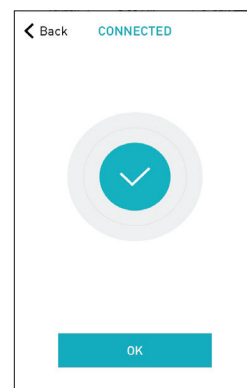

17. Your Bridge should connect to your Wi-Fi network and direct you to the Connected screen. Press OK. Name your Bridge and click finish to complete the Wi-Fi connection process.

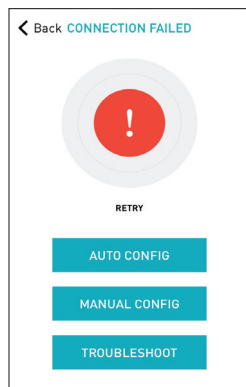

18. In the event that after the manual config process completes you are directed to the Connection Failed screen again. Confirm your Bridge is either blinking blue/purple or has started to blink 5 once every 5 seconds. If so, press the Troubleshoot button.

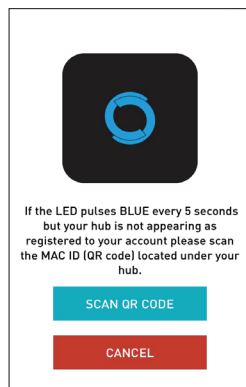

19. This will allow you to manually connect the Wi-Fi Bridge to your App. Press "Scan QR Code" You must allow TheShadeStore app rights to use your smartphone/tablet camera when prompted.

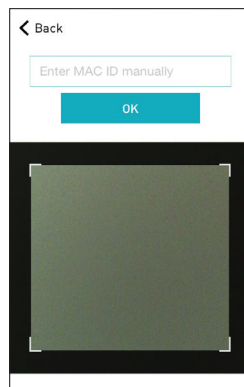

20. On the bottom of your Wi-Fi Bridge there will either be a Number/Letter code or a small QR code. Use the camera to scan the QR code or manually type in the Number/Letter code and press OK.

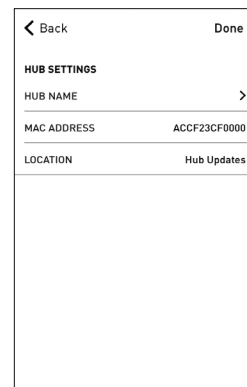

21. On the settings screen you will be prompted to name your Wi-Fi Bridge. Name your Bridge and press OK to complete the Wi-Fi connection process.

HOW TO LINK EACH SHADE TO THE APP:

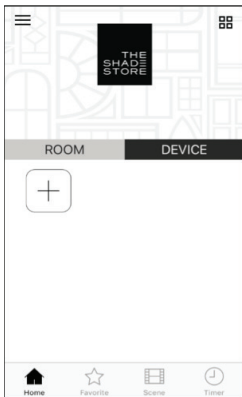

22. On the home screen select "Device" then select the "Plus" icon to add a new shade device.



23. Select from the list the hub to which you wish to pair a shade and select "Next".

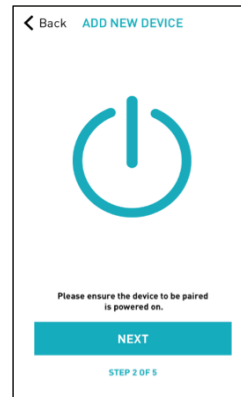

24. Make sure the shade device is plugged in or ready to be paired and select "Next".

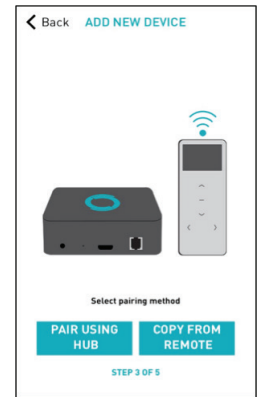

25. Choose your pairing method: "PAIR USING HUB" or "COPY FROM REMOTE".

HOW TO LINK EACH SHADE TO THE APP:

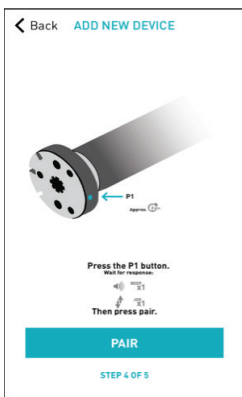

26A. PAIR USING HUB
(Requires access to the motor head)

- Press and hold the "P1" button on the motor head 2 seconds. The motor will jog up and down once and you will hear one audible beep
- Press "Pair" on the app screen "Next".

OR

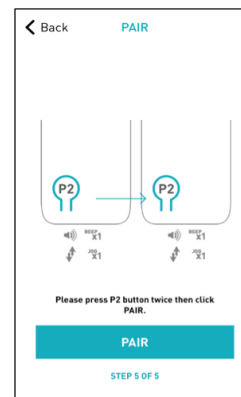

26B. COPY FROM REMOTE
(Only requires remote in hand)

- Make sure the remote is tuned to the shade's individual channel (not Ch 0).
- Remove the remote battery cover and press the upper left P2 button next to the battery. The motor will jog up and down once and you will hear one audible beep.
- Press the upper left P2 button again. The motor will jog up and down once and you will hear one audible beep.
- Press "Pair" on the app screen.

PAIRING COMPLETE

Once the motors have paired, the application will take you directly to the shade properties screen to edit the settings for your treatment.

HOW TO EDIT SETTING FOR EACH SHADE:

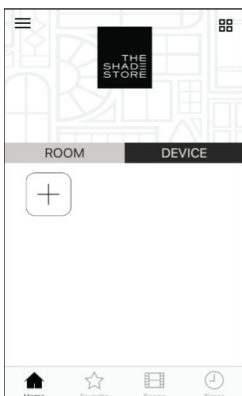

27. Select the device.

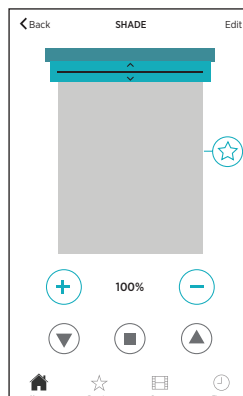

28. Select "Edit" in the upper right corner.

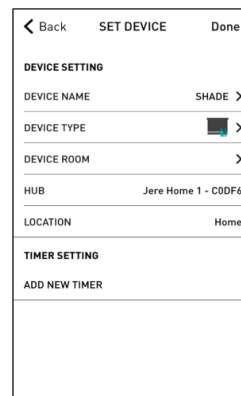

29. Modify Device Name to customize your treatment name.

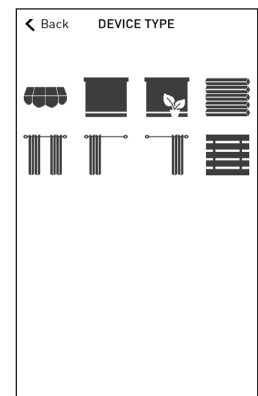

30. Modify Device Type to the representative icon of your product.

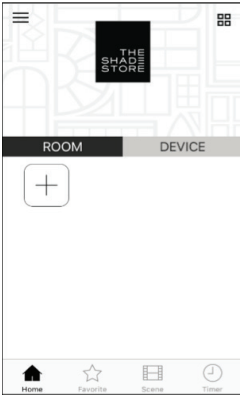

31. Once all shades are linked to the application. Select the "Plus" icon to add a new room designation, return to the home screen, Select "Room".

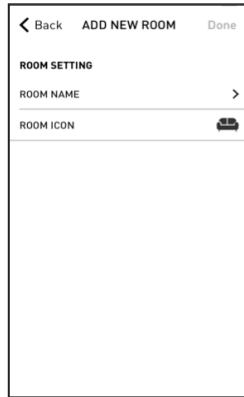

32. Name the room, pick the room icon and click "Done".

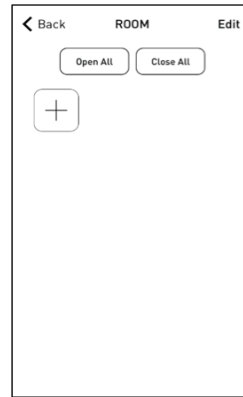

33. Select the newly created room and select the "Plus" icon to add a linked shade to the room.



34. Select "Add Existing Device" to select treatments from the dropdown to add to the room. (Choosing "Add New Device" will revert back to the pairing a new device sequence.)

SETUP COMPLETE

Your mobile application setup and product pairing is now complete. Shades added to rooms can be controlled simultaneously after selecting the desired room. See the following sections for instructions on creating scenes, setting timers and troubleshooting pairing failures.

35. CREATING SCENES:

Once you have completed the pairing process for the Wi-Fi bridge and linked all of your shades to the application, you can create scenes to set a treatment or group of treatments to specific heights.

1. On the lower menu bar select the Scene icon.
This will take you to the scene homepage.
2. Select "Add New Scene" to begin programming your desired scene.
3. Input your scene name and select a scene picture.
4. You can choose custom heights (by %) or set open/closed for all selected treatments. (If you select custom you must select a treatment height for each selected treatment)
5. Select "Add New Device" to add your treatment to the scene being created.
6. Set the treatment height percentage if necessary.
7. Select "Done" to finalize your scene.

You can activate your custom scene by navigating to the scene menu, and pressing "GO" next to the desired scene name. If you wish to set a programmed timer to activate your scene or individual shades, please see the next section "Programming Timers".

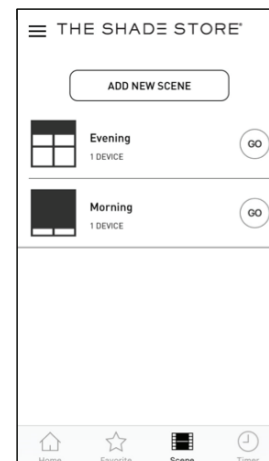

Steps 1 & 2

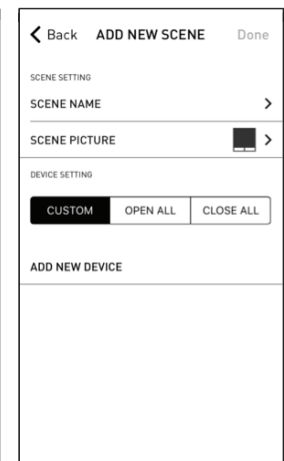

Steps 3, 4, 5, 6, & 7

35. CREATING SCENES:

Once you have completed the pairing process for the Wi-Fi bridge and linked all of your shades to the application, you can create scenes to set a treatment or group of treatments to specific heights.

1. On the lower menu bar select the Scene icon.
This will take you to the scene homepage.
2. Select "Add New Scene" to begin programming your desired scene.
3. Input your scene name and select a scene picture.
4. You can choose custom heights (by %) or set open/closed for all selected treatments. (If you select custom you must select a treatment height for each selected treatment)
5. Select "Add New Device" to add your treatment to the scene being created.
6. Set the treatment height percentage if necessary.
7. Select "Done" to finalize your scene.

You can activate your custom scene by navigating to the scene menu, and pressing "GO" next to the desired scene name. If you wish to set a programmed timer to activate your scene or individual shades, please see the next section "Programming Timers".

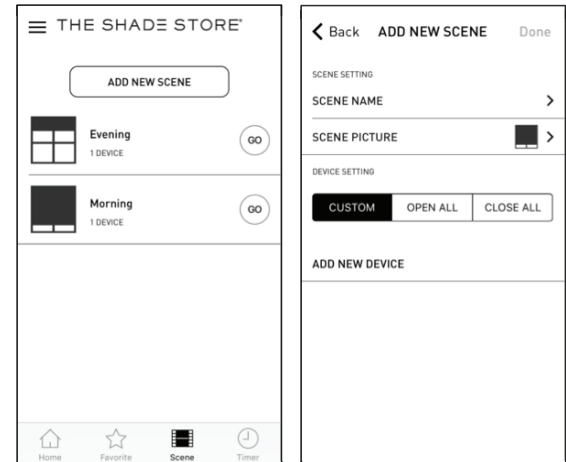

Steps 1 & 2

Steps 3, 4, 5, 6, & 7

36. PROGRAMMING TIMERS:

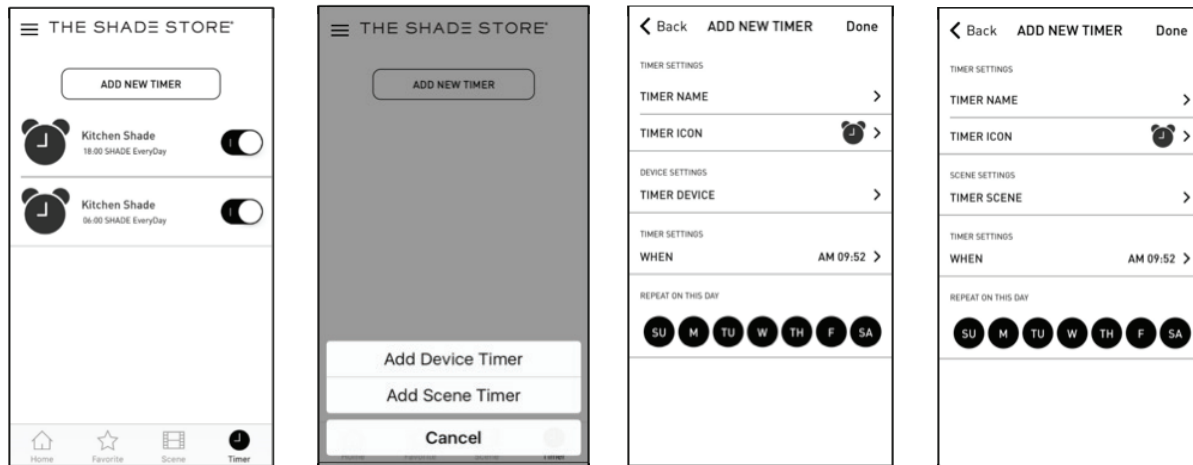

Steps 1 & 2

Step 3

Steps 4 & 5







Steps 6, 7 & 8

You can program timers to trigger the specific operation of your shades and scenes at your desired times throughout the day.

1. On the lower menu bar select the Timer icon. This will take you to the Timer homepage.
2. Select "Add New Timer" to begin programming your desired timer.
3. Select either "Add Device Timer" or "Add Scene Timer"
4. Input your timer name and select a timer picture.
5. Add the devices or scenes you wish to operate.
6. Set the time you wish the timer to trigger shade control.
7. Select the days you wish the timer to operate. (Black dot signifies the timer will repeat on that day)
8. Select "Done" to finalize your timer.

You can turn your timer on or off to accommodate changes to your regular schedule. Slide the on/off selector on the Timer homepage next to the desired timer to activate or deactivate the time based control.

LED INDICATION:

COLOR	RESPONSE	STATUS
	Flashes Twice	Power On
	Continuous Flashing	Wi-Fi Bridge is in pairing mode
	Flashes Three Times	Wi-Fi Bridge has been reset for manual configuration
	On	App is connected to Wi-Fi Bridge
	Continuous Flashing Blue to Purple	Wi-Fi Bridge is connected to Wi-Fi router (no cloud connection)
	1 Flash Every 5 Seconds	Wi-Fi Bridge is connected to cloud server and is in stand-by mode
	Continuous Flashing	Wi-Fi Bridge is not connected to Wi-Fi and is actively searching for a Wi-Fi signal
	Flashing	Wi-Fi Bridge's firmware is being updated

TROUBLESHOOTING:

The following scenarios are common issues that may cause connectivity problems during the Wi-Fi bridge pairing process. If you cannot achieve success connecting the Wi-Fi Bridge to your network, please reference the below most common pairing roadblocks.

I CANNOT CONNECT TO MY HIDDEN WI-FI NETWORK.

The Shade Store Wi-Fi Bridge does not currently support pairing with hidden networks. To connect to a hidden network, you will need to unhide the network. Once the network pairing process is complete you can re-hide the network and the Wi-Fi Bridge will work without issue.

I HAVE MULTIPLE ACCESS POINTS AND CANNOT COMPLETE THE PAIRING PROCESS.

If you have multiple wireless access points we recommend that you turn off all but one to complete the network pairing process. Once this is complete you can turn on all of the wireless access points and the Wi-Fi Bridge will work without issue.

I CANNOT CONNECT TO MY 5GHZ WI-FI NETWORK.

The Shade Store Wi-Fi Bridge does not currently support operation over a 5GHz network. It operates on a 2.4GHz network. Most routers are dual band and can support both network configurations. Please make sure that the 2.4GHz band is turned on in your wireless router's settings.

NETWORK SECURITY SETTINGS ARE INTERFERING WITH THE SETUP PROCESS.

Some companies or large corporate offices have network security settings more advanced than the typical homeowner. If you are setting up in this environment please consult your network administrator. It may be necessary to enable device-to-device communication. One solution is to use a device with a mobile data connection available in the back-ground to complete the set-up process.

MY WI-FI BRIDGE IS NOT CONSISTENTLY WORKING.

There are many things that can interfere with the radio communication that the Wi-Fi Bridge uses. Try positioning the Wi-Fi Bridge in a different location and/or closer to the shade to improve performance. Due to varying levels of interference it may be necessary to purchase additional Wi-Fi bridges to extend the coverage throughout your location.

IF YOU STILL CANNOT PAIR THE WI-FI BRIDGE WITH YOUR WI-FI NETWORK:

Please contact 800.754.1455 or help@theshadestore.com for further customer assistance.

AMX HUB DRIVER INSTALLATION:

1. Find Rollease Arc Example file- downloadable at AMX third party tech center. Open with Netlinx.

Name	Date modified	Type	Size
Packaged	12/21/2017 9:05 AM	File folder	
.gitignore	12/21/2017 9:02 AM	GITIGNORE File	1 KB
Duet Rollease Acmeda ARC Interface.doc	1/4/2018 4:23 PM	Microsoft Word 9...	175 KB
MotorComponent.axs	12/20/2017 6:52 PM	NetLinx Studio 4 A...	9 KB
MotorComponent.src	1/15/2018 1:25 PM	SRC File	28 KB
MotorComponent.tkn	1/15/2018 1:25 PM	TKN File	103 KB
MotorComponent.tko	1/15/2018 1:25 PM	TKO File	534 KB
Rollease Acmeda ARC Example.apw	12/15/2017 2:51 PM	NetLinx Studio 4 A...	5 KB
Rollease Acmeda ARC Example.apw	1/15/2018 2:48 PM	NetLinx Studio 4 A...	7 KB
Rollease Acmeda ARC Example.src	1/15/2018 1:26 PM	SRC File	31 KB
Rollease Acmeda ARC Example.tkn	1/15/2018 1:26 PM	TKN File	1,856 KB
Rollease Acmeda ARC Example.tko	1/15/2018 1:26 PM	TKO File	532 KB
Rollease Acmeda Netlinx Demo.TP4	1/15/2018 2:19 PM	TP4.Document	2,059 KB

2. Click Tools. Select File Transfer.

Type	Status	Bytes Transferred	Connection	ID	File	Path	Name	Last Status
File	Complete	1000000 of 1000000	200.100.100.100	1	MotorComponent.apw	C:\Users\ADMIN\Documents\Netlinx\Rollease Acmeda ARC Example.apw	MotorComponent.apw	Done
File	Complete	2000000 of 2000000	200.100.100.100	2	MotorComponent.src	C:\Users\ADMIN\Documents\Netlinx\Rollease Acmeda ARC Example.src	MotorComponent.src	Done
File	Complete	1000000 of 1000000	200.100.100.100	3	MotorComponent.tkn	C:\Users\ADMIN\Documents\Netlinx\Rollease Acmeda ARC Example.tkn	MotorComponent.tkn	Done
File	Complete	5000000 of 5000000	200.100.100.100	4	MotorComponent.tko	C:\Users\ADMIN\Documents\Netlinx\Rollease Acmeda ARC Example.tko	MotorComponent.tko	Done
File	Complete	1000000 of 1000000	200.100.100.100	5	Rollease Acmeda ARC Example.apw	C:\Users\ADMIN\Documents\Netlinx\Rollease Acmeda ARC Example.apw	Rollease Acmeda ARC Example.apw	Done
File	Complete	3000000 of 3000000	200.100.100.100	6	Rollease Acmeda ARC Example.src	C:\Users\ADMIN\Documents\Netlinx\Rollease Acmeda ARC Example.src	Rollease Acmeda ARC Example.src	Done
File	Complete	1800000 of 1800000	200.100.100.100	7	Rollease Acmeda ARC Example.tkn	C:\Users\ADMIN\Documents\Netlinx\Rollease Acmeda ARC Example.tkn	Rollease Acmeda ARC Example.tkn	Done
File	Complete	500000 of 500000	200.100.100.100	8	Rollease Acmeda ARC Example.tko	C:\Users\ADMIN\Documents\Netlinx\Rollease Acmeda ARC Example.tko	Rollease Acmeda ARC Example.tko	Done
File	Complete	2000000 of 2000000	200.100.100.100	9	Rollease Acmeda Netlinx Demo.TP4	C:\Users\ADMIN\Documents\Netlinx\Rollease Acmeda Netlinx Demo.TP4	Rollease Acmeda Netlinx Demo.TP4	Done

3. File Transfer window will open. Assuming connection settings are established and functional. Select “Rollease Acmeda Arc Example” file to send to control system. Click SEND.

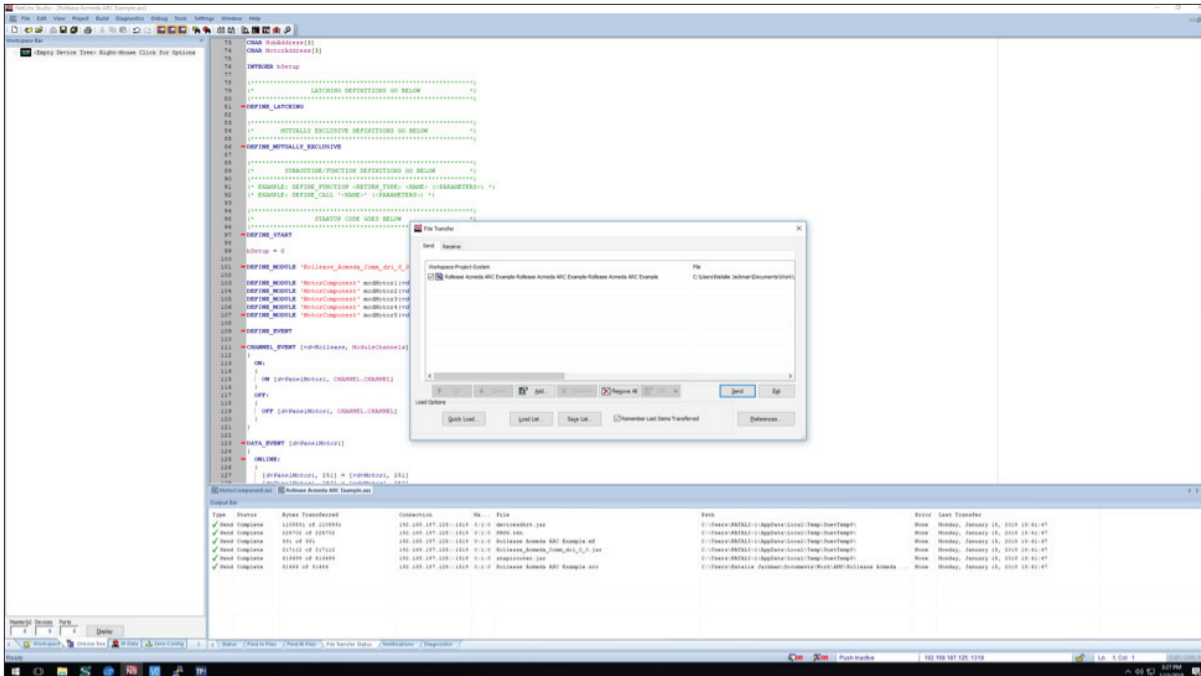

4. Interface will present on touchpanel.
5. Click “Command Processor” button. Button will illuminate orange.

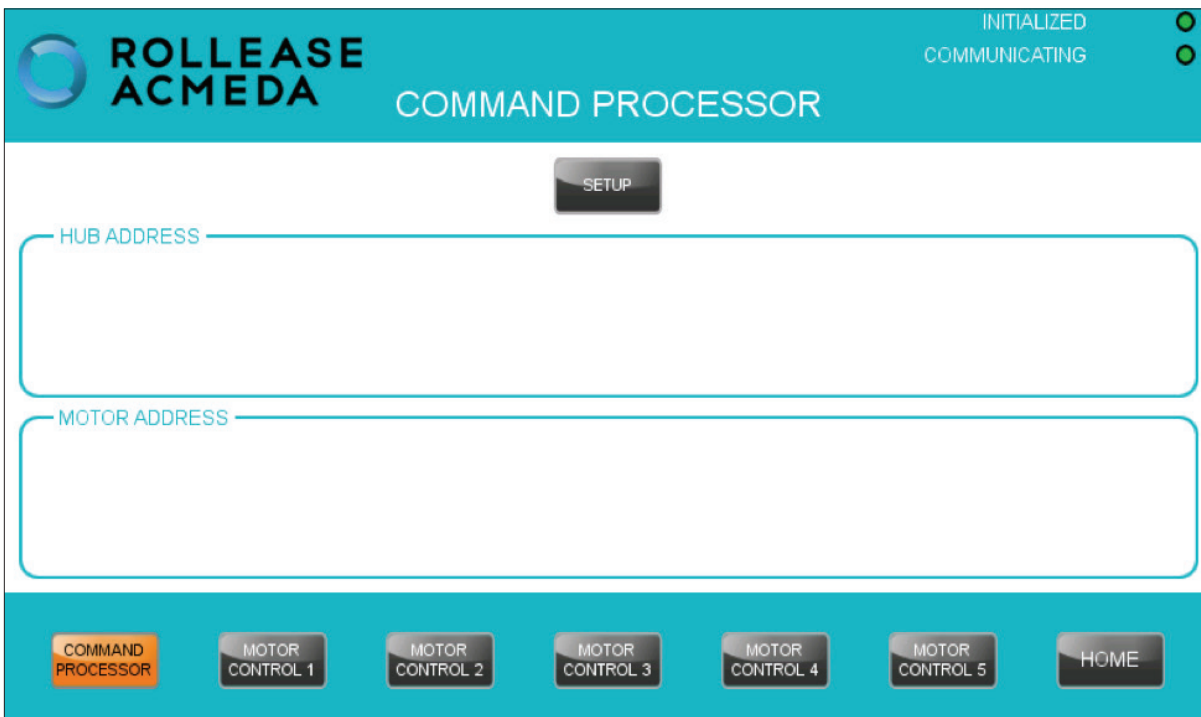

6. Click "Setup". Button will illuminate orange

The screenshot shows the Rollease Acmeda Command Processor interface. At the top, there is a teal header with the Rollease Acmeda logo on the left, the text "COMMAND PROCESSOR" in the center, and status indicators "INITIALIZED" and "COMMUNICATING" with green dots on the right. Below the header, there is a white area with a teal border. In the center of this area is an orange "SETUP" button. Below the button are two large, empty text input fields. The first field is labeled "HUB ADDRESS" and the second field is labeled "MOTOR ADDRESS". At the bottom of the interface is a teal footer containing a row of buttons: "COMMAND PROCESSOR" (highlighted in orange), "MOTOR CONTROL 1", "MOTOR CONTROL 2", "MOTOR CONTROL 3", "MOTOR CONTROL 4", "MOTOR CONTROL 5", and "HOME".

7. Using a remote or The Shade Store App, move each shade to initiate a response in order to identify address.
8. Hub and motor addresses will automatically populate. Jog each motor in RA app to identify address.

The screenshot shows the Rollease Acmeda Command Processor interface, similar to the previous one, but with the addresses populated. The "HUB ADDRESS" field now contains the number "719" and the "MOTOR ADDRESS" field now contains the number "002". The "SETUP" button remains orange. The footer buttons are the same as in the previous screenshot.

9. Once you have identified each shade, configure the RA module for each hub/motor in Netlinx. Refer to “Duet Rollease Acmeda ARC Interface” document located in the zip file in the Duet module for advanced system configuration.

```
148 ///////////////////////////////////////////////////  
149 // Configure Rollease Acmeda Virtual Devices  
150 ///////////////////////////////////////////////////  
151 SEND_COMMAND vdvRollease, " 'COMPONENTADD-', ITOA(vdvMotor1.PORT), ',MOTOR[001] '"  
152 SEND_COMMAND vdvRollease, " 'COMPONENTADD-', ITOA(vdvMotor2.PORT), ',MOTOR[002] '"  
153 SEND_COMMAND vdvRollease, " 'COMPONENTADD-', ITOA(vdvMotor3.PORT), ',MOTOR[003] '"  
154 SEND_COMMAND vdvRollease, " 'COMPONENTADD-', ITOA(vdvMotor4.PORT), ',MOTOR[004] '"  
155 SEND_COMMAND vdvRollease, " 'COMPONENTADD-', ITOA(vdvMotor5.PORT), ',MOTOR[005] '"  
156
```

INTEGRATION DIAGRAM:

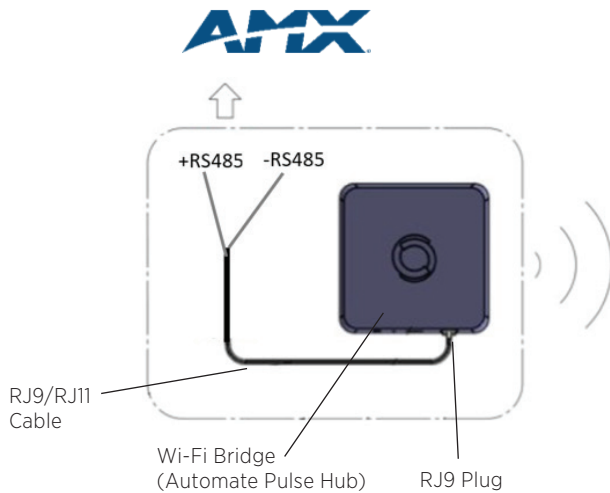

WI-FI BRIDGE CONNECTIONS:

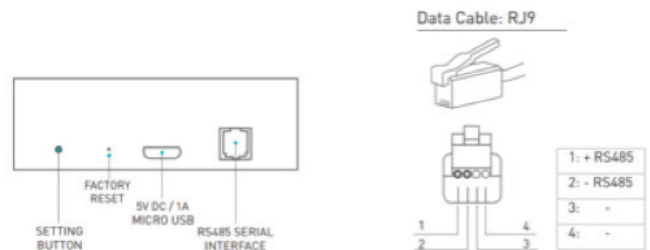

FREQUENTLY ASKED QUESTIONS:

NO WI-FI BRIDGE (AUTOMATE PULSE HUB) DETECTED.

Make sure that the correct 485 port is defined on the AMX controller.

SHADE LIMITS ARE NOT SET PROPERLY

Calibrate shade limits with your remote control before configuring shade in AMX system.

SHADE IS NOT MOVING AT ALL

Make sure the selected Wi-Fi Bridge (Automate Pulse Hub) is the correct Wi-Fi Bridge (Automate Pulse Hub) for the shade to be controlled.

I HAVE MULTIPLE WI-FI BRIDGES (AUTOMATE PULSE HUBS), WHAT DO I DO?

Multiple Hubs are automatically detected during discovery.

HOW DO I SCAN FOR AVAILABLE HUBS?

Utilize the Touchpanel to scan motors/hubs as they are moved from the TSS app or remote control.

SUPPORT RESOURCES:

THE SHADE STORE

800.754.1455

help@theshadestore.com

M-F 9am-8pm EST

SAT. 9am-6pm EST

CONTROL CONCEPTS

201.797.7900

M-F 8am-5pm EST